

# HSF

**NOTES:**

- Rated Current:1.5AMP
- Contact Resistance:30mΩ max
- Withstand Voltage:500V AC/DC
- Insulation Resistance:1000MΩ min
- Operation Temperature:-55℃ to +125℃
- Contact Material:Brass
- Contact Plating:Au or Sn Over Ni
- Insulator Material:PA6T+30%G.F UL94V-0

Recommended P.C.B Layout(Top Side)  
(PCB BOARD TOLERANCE±0.05)

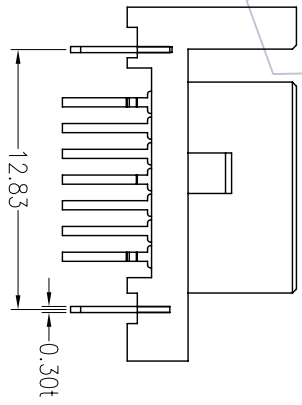
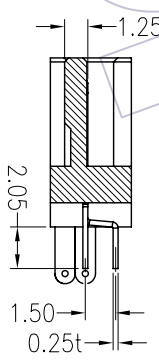
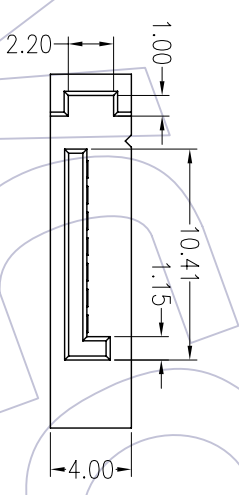
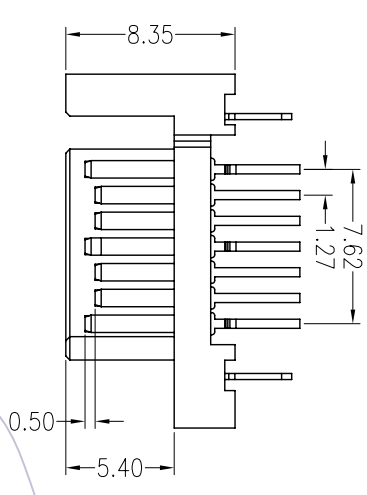
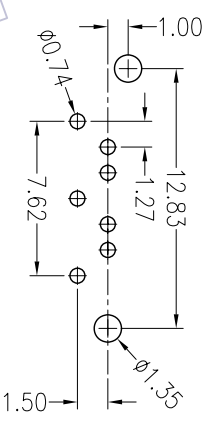

## Ordering Information

5410-07 D1 XX C 0 1

- Contact Plating
- G0=Gold Flash
- G1=3u"Gold
- G2=5u"Gold
- G3=10u"Gold
- G4=15u"Gold
- G5=30u"Gold
- S0=Gold Flash/Tin
- S1=3u"Gold/Tin
- S2=5u"Gold/Tin
- S3=10u"Gold/Tin
- S4=15u"Gold/Tin
- S5=30u"Gold/Tin
- SN=Tin

REV	DATE	MODIFICATION DESCRIPTION	CHANGE	APPROVE	OPERATION	DRAW	SCALE	PART NO.	TITLE:
A0	09/03/12	NEW			X.X ±0.40	William Chen DESIGN	1:1 mm	5410-07D1XXC01	SATA 7P MALE CONNECTOR 180° DIP
					X.XX ±0.25	CHECK			
					X.XXX ±0.15	APPROVE			
					Angle ± 3'	PROJ.			

**WCON** 维峰五金电子有限公司  
WAFER HARDWARE ELECTRONICS CO.,LTD