

WAFER

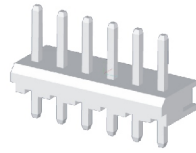

Current Rating: 3.0AMP
 Contact Resistance: 20mΩ Max.
 Insulation Resistance: 1000MΩ Min.
 Withstanding Voltage : 800V AC/Minute
 Operation Temperature: -25°C to +85°C
 Contact Material: Brass
 Contact plating: Au or Tin Over Ni
 Insulator Material: Polyester (UL94V-0)
 Standard: PA6T

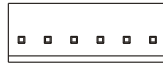

WF2508-WS XXWX1

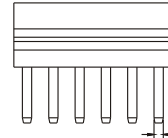

WF2508-WRXXWX1

WF2508-XX XX W 01

TERMINAL
 SHAPE
 WS: Wafer 180°
 WR: Wafer 90°

NO. OF Pins
 02~25pin

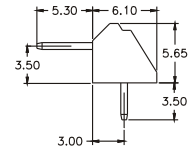
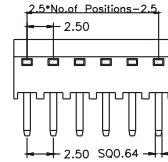
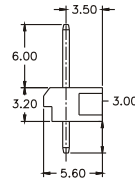
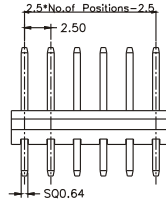

HOUSING

Insulator Material: Polyester (UL94V-0)
 Standard: PA66
 Use with : WF2507-T (Crimple Terminal)
 Mated with : WF2507-Wafer

WF2508-H XX W 01

NO. OF Pins
 02~25pin

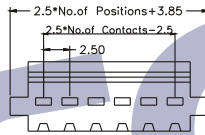

WF2508-HXXW01

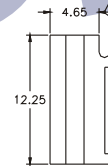
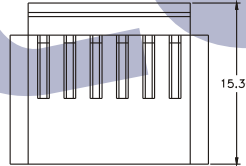

TERMINAL

Material: Phosphor Bronze
 Contact plating: Au or Sn Over Ni
 Insulation O.D.: 1.90mm (Max.)
 Wire Range: AWG#22~#28

WF2508-T P SN 01

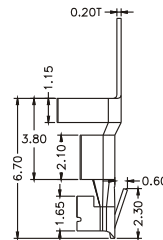
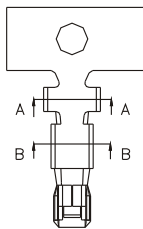

WF2508-TPSN01

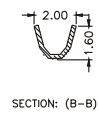
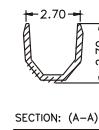
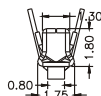

※ INNOVATION AND DEVELOPMENT ※ CONTINUAL IMPROVEMENT ※ QUALITY FOREMOST ※ CUSTOMER SATISFACTION ※

Http:www.wafe-china.com E-mail:sales@wafe-china.com

WAFE DONGGUAN FAX:+86 769 85358915 TEL:+86 769 85358920
 WAFE KUNSHAN FAX:+86 512 57468468 TEL:+86 512 57468418