

WCON[®] Wafer/Housing Connector

HTTP:WWW.WAFE-CHINA.COM

WAFER

Current Rating:1.25AMP
 Contact Resistance:20mΩ Max.
 Insulation Resistance:500MΩ Min.
 Withstanding Voltage :500V AC/Minute
 Operation Temperature:-25°C to+85°C
 Contact Material:Brass
 Contact plating:Gold/Tin Over Ni
 Insulator Material:Polyester (UL94V-0)
 Standard:PA6T

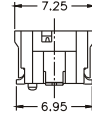
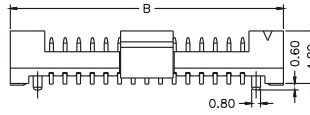
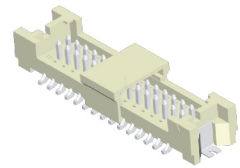
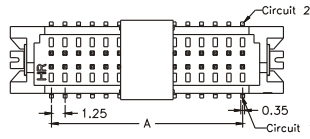

WF1253-WM XX E T 1

NO.OF Pins PACKING
 A:Tray
 T:Tube
 P:Tube+CAP
 R:Tape&Reel

| POLES | DIM"A" | DIM"B" |
|-------|--------|--------|
| 2*05 | 5.00 | 12.50 |
| 2*07 | 7.50 | 15.00 |
| 2*10 | 11.25 | 18.75 |
| 2*15 | 17.50 | 25.00 |
| 2*20 | 23.75 | 31.25 |

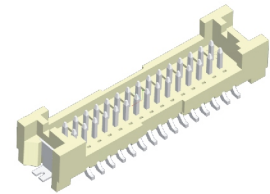
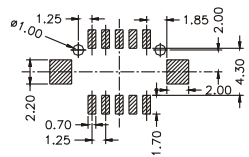
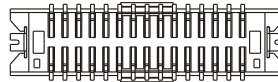

WF1253-WMXXE1

HOUSING

Insulator Material:Polyester (UL94V-0)
 Standard:PA66
 Use with :WF1253-T(Crimple Terminal)
 Mated with :WF1253-Wafer

WF1253-H XX X 01

NO.OF Pins

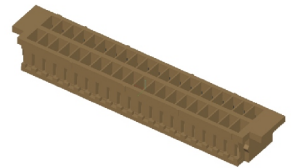
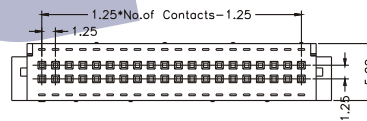
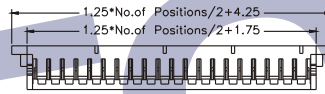

WF1253-HXXX01

TERMINAL

Material:Phosphor Bronze
 Contact plating: Sn Over Ni
 Insulation O.D.:0.90mm (Max.)
 Wire Range:AWG#28~#32

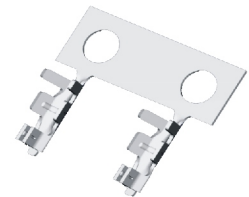
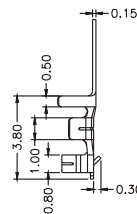
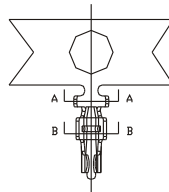

WF1253-TPSN01

WF1253-T P SN 01

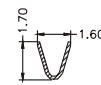

SECTION: (A-A)

SECTION: (B-B)

※INNOVATION AND DEVELOPMENT ※CONTINUAL IMPROVEMENT ※QUALITY FOREMOST ※CUSTOMER SATISFACTION ※

Http:www.wafe-china.com E-mail:sales@wafe-china.com

WAFE DONGGUAN FAX:+86 769 85358915 TEL:+86 769 85358920
 WAFE KUNSHAN FAX:+86 512 57468468 TEL:+86 512 57468418