

# HSPF

## TECHNICAL SPECS:

Current Rating: 1.0AMP  
 Contact Resistance: 10mΩ Max  
 Dielectric Strength: Min 1000Vrms  
 Mechanical Life: Min 100 cycles  
 Connecting Pin:  $\phi 0.47$ mm  
 Operation Temperature: -40°C to +105°C

Sleeve: Brass CuZn36Pb3(C360000)  
 Contact plating: Au or Sn over Ni  
 Insulator Material: PPS+30%G.F(UL94V-0)  
 06P~16P Insulators without center bar  
 36P~52P Insulators with center two bar  
 64P Insulators with center three bar

## Ordering Information

3560-30X XX S XX 100 X 1

Row of Pitch No. of Pin Contact Plating Packaging  
 1=7.62mm G0=Gold Flash T=Tube  
 2=15.24mm G1=3u"Gold See tab A=Tray  
 3=10.16mm G2=5u"Gold  
 5=22.86mm G3=10u"Gold  
 G4=15u"Gold  
 G5=30u"Gold  
 S0=Gold Flash/Tin  
 S1=3u"Gold/Tin  
 S2=5u"Gold/Tin  
 S3=10u"Gold/Tin  
 S4=15u"Gold/Tin  
 S5=30u"Gold/Tin  
 SN=Tin

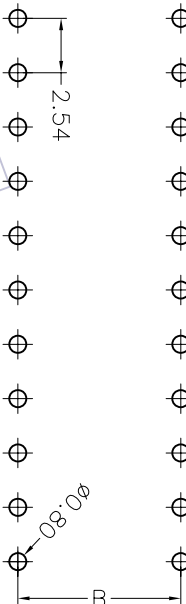
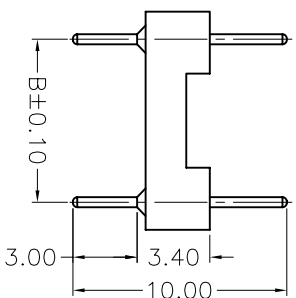
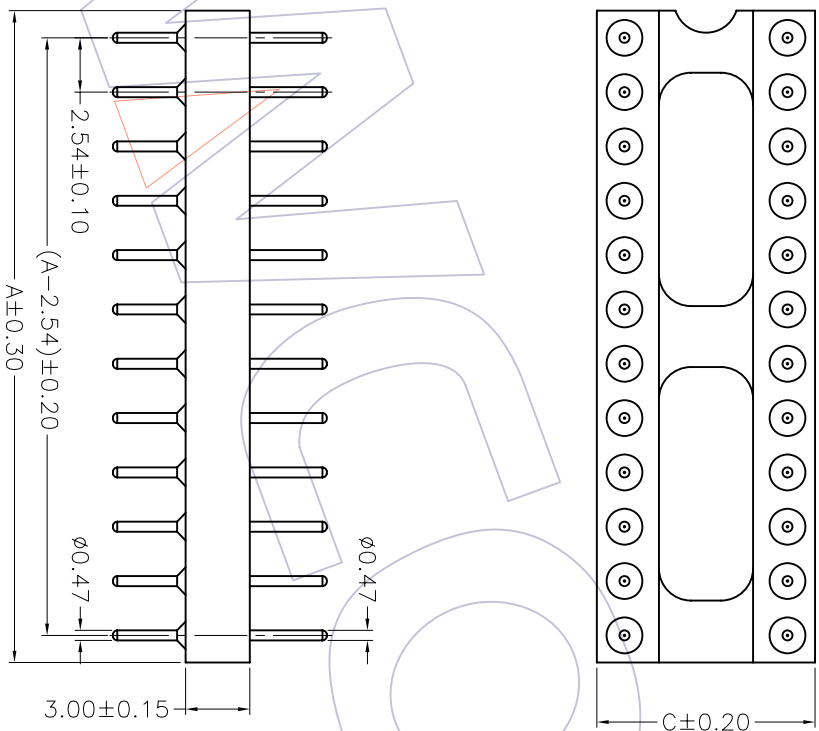

Recommended P.C.B Layout(Top Side)  
 (PCB BOARD TOLERANCE±0.05)

Dimensional & Ordering Information

NO. of Poles	Part No.	Dimension		
		A	B	C
06	3560-30106SXX100X1	7.62	7.62	10.20
08	3560-30108SXX100X1	10.16	7.62	10.20
10	3560-30110SXX100X1	12.70	7.62	10.20
12	3560-30112SXX100X1	15.24	7.62	10.20
14	3560-30114SXX100X1	17.78	7.62	10.20
16	3560-30116SXX100X1	20.32	7.62	10.20
18	3560-30118SXX100X1	22.86	7.62	10.20
20	3560-30120SXX100X1	25.40	7.62	10.20
22	3560-30122SXX100X1	27.94	7.62	10.20
24	3560-30124SXX100X1	30.48	7.62	10.20
28	3560-30128SXX100X1	35.56	7.62	10.20
20	3560-30320SXX100X1	25.40	10.16	12.70
22	3560-30322SXX100X1	27.94	10.16	12.70
24	3560-30324SXX100X1	30.48	10.16	12.70
28	3560-30328SXX100X1	35.56	10.16	12.70
32	3560-30332SXX100X1	40.64	10.16	12.70
24	3560-30224SXX100X1	30.48	15.24	17.80
28	3560-30228SXX100X1	35.56	15.24	17.80
32	3560-30232SXX100X1	40.64	15.24	17.80
36	3560-30236SXX100X1	45.72	15.24	17.80
40	3560-30240SXX100X1	50.80	15.24	17.80
42	3560-30242SXX100X1	53.34	15.24	17.80
48	3560-30248SXX100X1	60.96	15.24	17.80
50	3560-30250SXX100X1	63.50	15.24	17.80
52	3560-30252SXX100X1	66.04	15.24	17.80
50	3560-30550SXX100X1	63.50	22.86	25.40
52	3560-30552SXX100X1	66.04	22.86	25.40
64	3560-30564SXX100X1	81.28	22.86	25.40

**WCON** 维峰五金电子有限公司  
 WAVE HARDWARE ELECTRONICS CO. LTD

SEE TAB

2.54mm MACHINED ADAPTER CONNECTOR  
 180° H=3.0 L=10.0

OPERATION	DRAW	WEIXD	SCALE	PART NO.
X.X	DESIGN	08/10/22	1:1	
X.XX	CHECK		mm	
X.XXX	CHECK		A4	
Angle	APPROVE		1/1	TITLE:
± 3'			PROJ.	Customer NO.

REV	DATE	MODIFICATION DESCRIPTION	CHANGE	APPROVE	DIM	TOL
A0	08/10/22	NEW				
1						