

HSPF

TECHNICAL SPECS:

Current Rating: 3.0AMP
 Contact Resistance: 10mΩ Max
 Dielectric Strength: Min 1000V/RMS
 Mechanical Life: Min 500 cycles
 Operation Temperature: -40°C to +105°C

Sleeve: Brass CuZn36Pb3(C360000)
 Connecting Pin: ϕ 0.60mm
 Contact plating: Au or Sn over Ni
 Insulator Material: PPS+30%G.F.(UL94V-0)



Recommended P.C.B Layout(Top Side)
 (PCB BOARD TOLERANCE±0.05)

Ordering Information

3510-301 XX S XX 119 X 1

No. of Pin
1~40PIN

Contact Plating
 G0=Gold Flash
 G1=3u"Gold
 G2=5u"Gold
 G3=10u"Gold
 G4=15u"Gold
 G5=30u"Gold
 S0=Gold Flash/Tin
 S1=3u"Gold/Tin
 S2=5u"Gold/Tin
 S3=10u"Gold/Tin
 S4=15u"Gold/Tin
 S5=30u"Gold/Tin
 SN=Tin

Packing
 A=Tray
 T=Tube

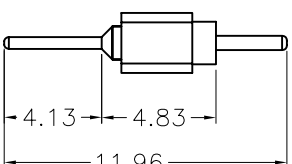
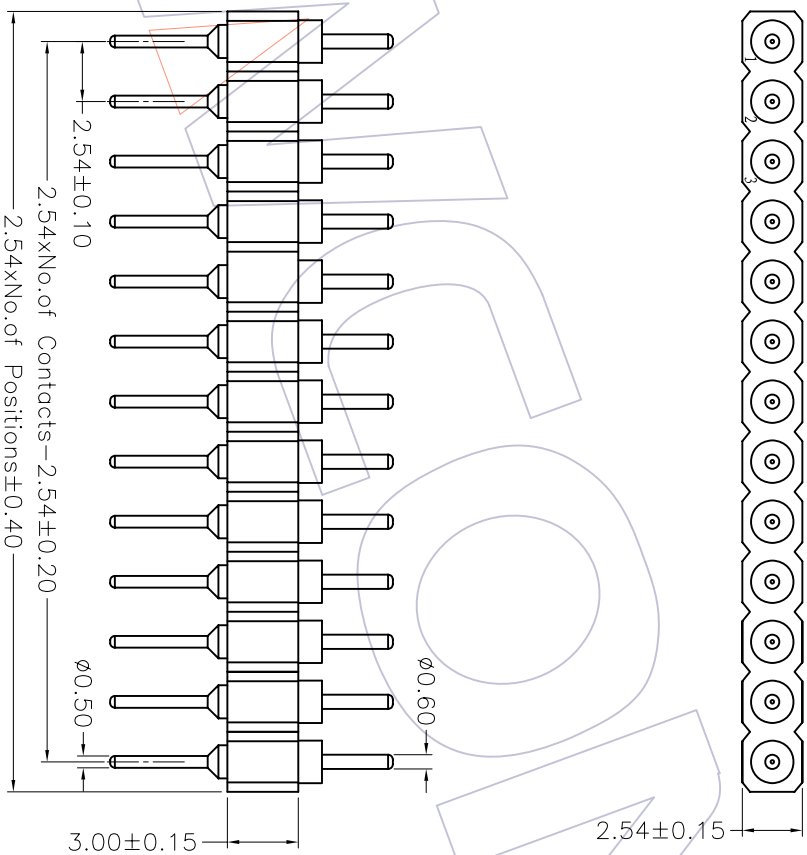

REV	DATE	MODIFICATION DESCRIPTION	CHANGE	APPROVE	OPERATION		DRAW	WEIXD	08/10/10	SCALE		PART NO.	TITLE:
					XXX	±0.40				DESIGN	UNIT		
A0	08/10/10	NEW			XXX	±0.25	CHECK			A4	3510-301XXSX119X1	2.54mm MACHINED PIN HEADER SINGLE ROW 180° H=3.00 L=11.96	
					Angle	± 3'	APPROVE			1/1	Customer NO.		
					DIM	TOL							

WCON 维峰五金电子有限公司
 WAFER HARDWARE ELECTRONICS CO.,LTD