

# HSPF

### TECHNICAL SPECS:

Current Rating: 3.0AMP  
 Contact Resistance: 10mΩ Max  
 Dielectric Strength: Min 1000V/RMS  
 Mechanical Life: Min 500 cycles  
 Operation Temperature: -40°C to +105°C

Sleeve: Brass CuZn36Pb3(C36000)  
 Connecting Pin:  $\phi 0.47$ mm  
 Contact plating: Au or Sn over Ni  
 Insulator Material: PPS+30%G.F(UL94V-0)

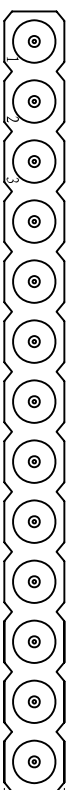

Recommended P.C.B Layout(Top Side)  
 (PCB BOARD TOLERANCE  $\pm 0.05$ )

## Ordering Information

3510-301 XX S XX 105 X 1

No. of Pin  
1~40PIN

Contact Plating  
G0=Gold Flash  
G1=3u"Gold  
G2=5u"Gold  
G3=10u"Gold  
G4=15u"Gold  
G5=30u"Gold  
S0=Gold Flash/Tin  
S1=3u"Gold/Tin  
S2=5u"Gold/Tin  
S3=10u"Gold/Tin  
S4=15u"Gold/Tin  
S5=30u"Gold/Tin  
SN=Tin

Packing  
A=Tray  
T=Tube

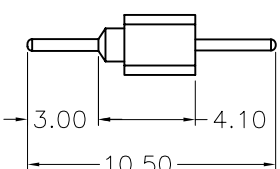
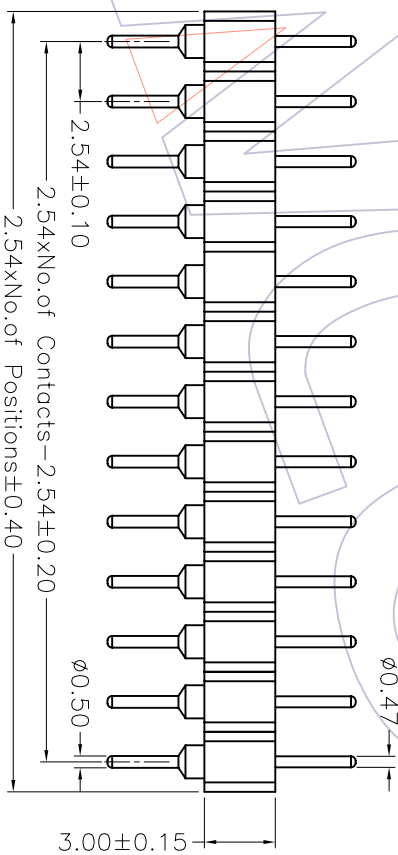

REV	DATE	MODIFICATION DESCRIPTION	CHANGE	APPROVE	OPERATION		DRAW	WEIXD	08/10/10	SCALE		PART NO.	TITLE:
					XXX	±0.40				DESIGN	UNIT		
A0	08/10/10	NEW			XXX	±0.25	CHECK	A4	3510-301XXSX105X1	2.54mm MACHINED PIN HEADER SINGLE ROW 180° $\phi=3.00$ L=10.5			
					Angle	± 3'	APPROVE					Customer NO.	

**WCON** 维峰五金电子有限公司  
 WAFE HARDWARE ELECTRONICS CO. LTD