

HSPF

TECHNICAL SPECS:

Current Rating: 1.0AMP
 Contact Resistance: 10mΩ Max
 Dielectric Strength: Min 500Vrms
 Mechanical Life: Min 500 cycles
 Mating Pin: $\phi 0.38$ to $\phi 0.50$ mm
 Forces: (polished steel gauge $\phi 0.41$ mm)
 -Insertion: 0.5N typ. -Withdrawal: 0.2N typ.
 Operation Temperature: -40°C to +105°C

Sleeve: Brass CuZn36Pb3(C360000)
 Contact Clip(3 finger): BeCu(C17200)
 Contact plating: Au or Sn over Ni
 Insulator Material: PPS+30%G.F(UL94V-0)

Recommended P.C.B Layout(Top Side)
 (PCB BOARD TOLERANCE ± 0.05)

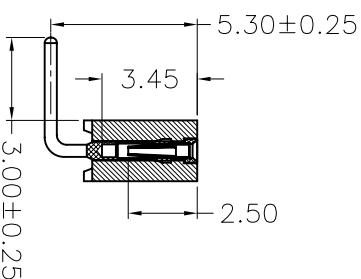
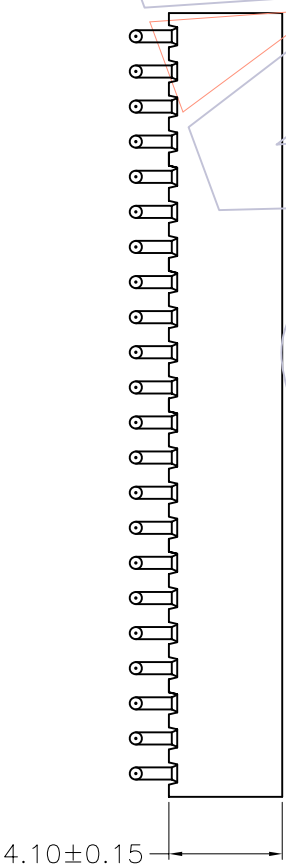
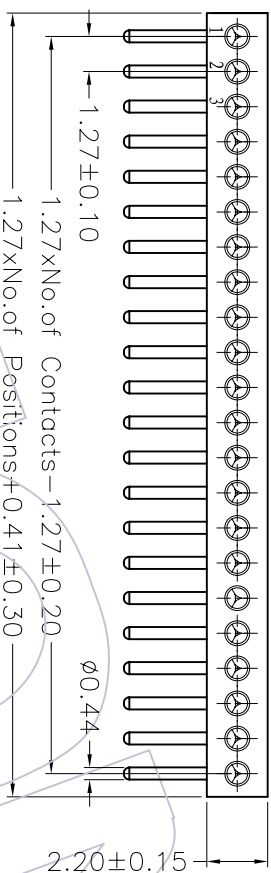

Ordering Information

3524-411 XXX R XX 092 X 1

- No. of Pin 2~50PIN
- Contact Plating G0=Gold Flash G1=3u"Gold G2=5u"Gold G3=10u"Gold G4=15u"Gold G5=30u"Gold S0=Gold Flash/Tin S1=3u"Gold/Tin S2=5u"Gold/Tin S3=10u"Gold/Tin S4=15u"Gold/Tin S5=30u"Gold/Tin SN=Tin
- Packing A=Tray T=Tube

REV	DATE	MODIFICATION DESCRIPTION	CHANGE	APPROVE	OPERATION		DRAW	WEIXD	08/10/13	SCALE		PART NO.	TITLE:
					Angle	± 3'				UNIT	mm		
A0	08/10/13	NEW			XXX	±0.40	DESIGN			1:1	A4	3524-411XXX092X1	1.27mm MACHINED FEMALE HEADER SINGLE ROW 90° H=4.1
					XXX	±0.25	CHECK						
					XXX	±0.15	APPROVE						
					DM	TOL							

WCON 维峰五金电子有限公司
 WAVE HARDWARE ELECTRONICS CO.,LTD