

HSPF

TECHNICAL SPECS:

Current Rating: 1.0AMP
 Contact Resistance: 10mΩ Max
 Dielectric Strength: Min 500Vrms
 Mechanical Life: Min 500 cycles
 Mating Pin: $\phi 0.38$ to $\phi 0.50$ mm
 Forces: (polished steel gauge $\phi 0.41$ mm)
 -Insertion: 0.5N typ. -Withdrawal: 0.2N typ.
 Operation Temperature: -40°C to +105°C

Sleeve: Brass CuZn36Pb3(C360000)
 Contact Clip (3 finger): BeCu(C17200)
 Contact plating: Au or Sn over Ni
 Insulator Material: PPS+30%G.F.(UL94V-0)

Ordering Information

3524-411 XXX S XXX 064 X 1

No. of Pin
2~50PIN

Contact Plating
G0=Gold Flash
G1=3u"Gold
G2=5u"Gold
G3=10u"Gold
G4=15u"Gold
G5=30u"Gold
S0=Gold Flash/Tin
S1=3u"Gold/Tin
S2=5u"Gold/Tin
S3=10u"Gold/Tin
S4=15u"Gold/Tin
S5=30u"Gold/Tin
SN=Tim

Packing
A=Tray
T=Tube

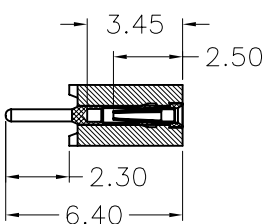
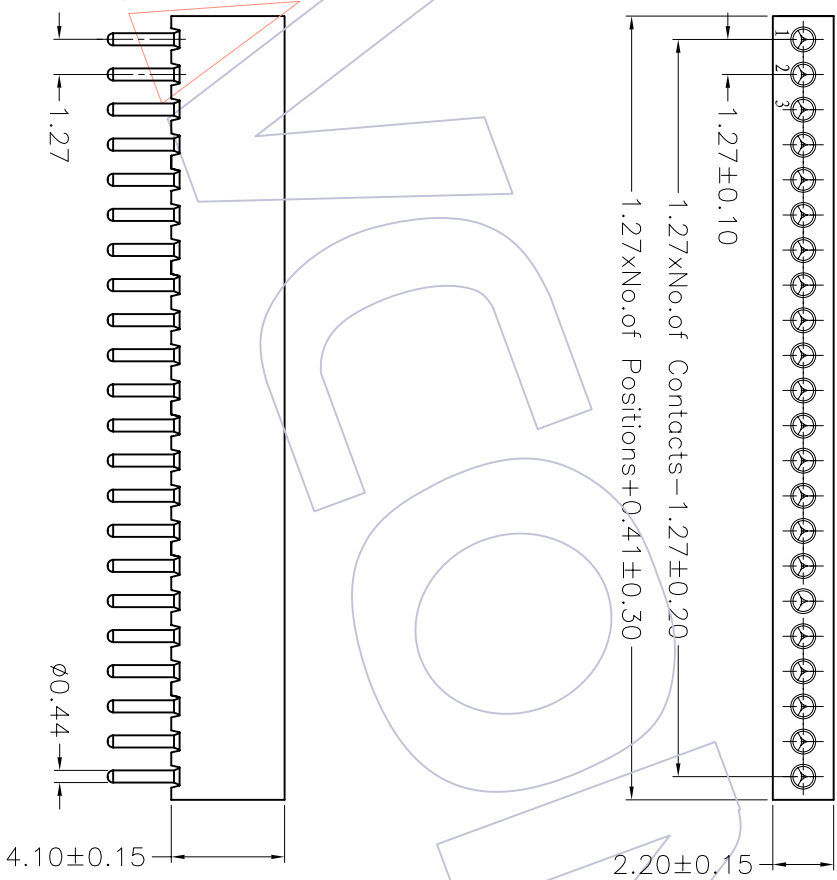

Recommended P.C.B Layout(Top Side)
 (PCB BOARD TOLERANCE±0.05)

1.27

$\phi 0.70 \pm 0.005$

REV	DATE	MODIFICATION DESCRIPTION	CHANGE	APPROVE	OPERATION		DRAW	WEIXD	08/10/13	SCALE		PART NO.	TITLE:	Customer NO.
					Dim	TOL				UNIT	mm			
A0	08/10/13	NEW			X.X	±0.40	DESIGN			mm	A4	3524-411XXX064X1	1.27mm MACHINED FEMALE HEADER SINGLE ROW 180° H=4.1	
					X.XXX	±0.25	CHECK				1/1			
					Angle	± 3'	APPROVE							

WCON 维峰五金电子有限公司
 WAFER HARDWARE ELECTRONICS CO.,LTD