

HSHF

NOTES:

Current Rating:3AMP
 Contact Resistance:30mΩ max
 Withstand Voltage:500V AC/DC
 Insulation Resistance:1000MΩ min
 Operation Temperature:--40°C to +105°C

Contact Material:BeCu t=0.2mm
 Contact plating:Au 3U",and plated Au area over Pd Ni 30U",other area plated fog Sn 100U" over Ni 30U"--50U"
 Insulator Material:LCP+30%GF (UL94V-0)

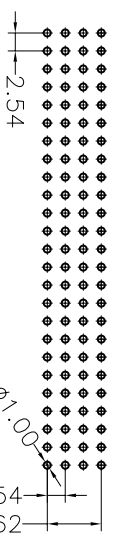
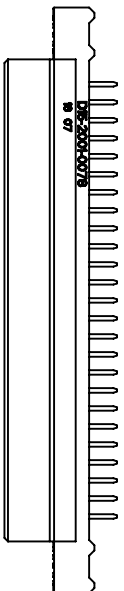

Ordering Information

3410-4 25 A F S XX N X 1

- Contact Plating
- G0=Gold Flash
- G1=3u"Gold
- G2=5u"Gold
- G3=10u"Gold
- G4=15u"Gold
- G5=30u"Gold
- S0=Gold Flash/Tin
- S1=3u"Gold/Tin
- S2=5u"Gold/Tin
- S3=10u"Gold/Tin
- S4=15u"Gold/Tin
- S5=30u"Gold/Tin
- SN=Tin

- Packing
- A=Tray
- T=Tube

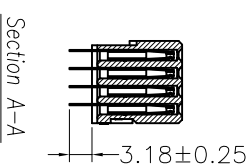
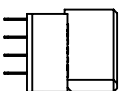
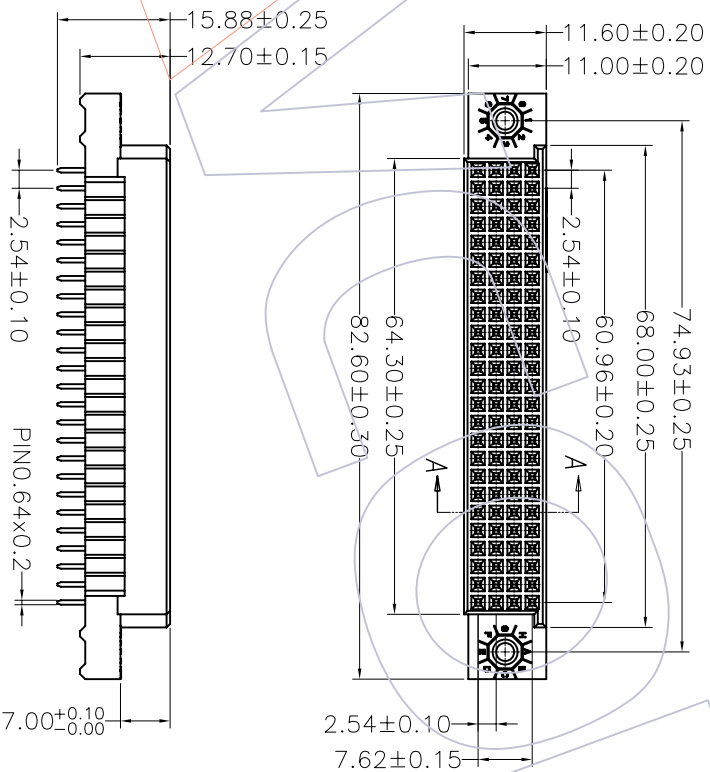

OPERATION	DRAW	WEIXD	SCALE	WCON 维峰五金电子有限公司 WAVE HARDWARE ELECTRONICS CO.,LTD	PART NO.	3410-425AFSXXXXX1
X.X	DESIGN	08/06/12	1:1		UNIT	
X.XX	CHECK		SIZE	A4	SHEET	1/1
X.XXX	APPROVE		PROJ.	Customer NO.	2.54 DIN SOCKET (EUROPE TYPE)	
Angle	± 3'					
± 0.15						
± 0.25						
± 0.40						
REV	DATE	MODIFICATION DESCRIPTION	CHANGE	APPROVE	DIM	TOL
A0	08/06/12	NEW				
1						