

HSP

NOTES:

Current Rating: 1.0AMP
 Contact Resistance: 20mΩ max
 Withstand Voltage: 500V AC/DC
 Insulation Resistance: 1000MΩ min
 Operation Temperature: -40°C to +105°C

Contact Material: Brass
 Contact plating: Au or Sn Over Ni
 Insulator Material: PA6T+30%GF(Ul94V-0)

Recommended P.C.B Layout(Top Side)
 (PCB BOARD TOLERANCE±0.05)

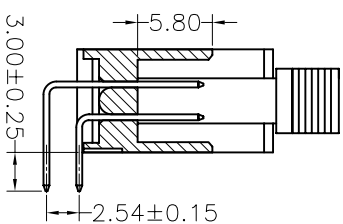
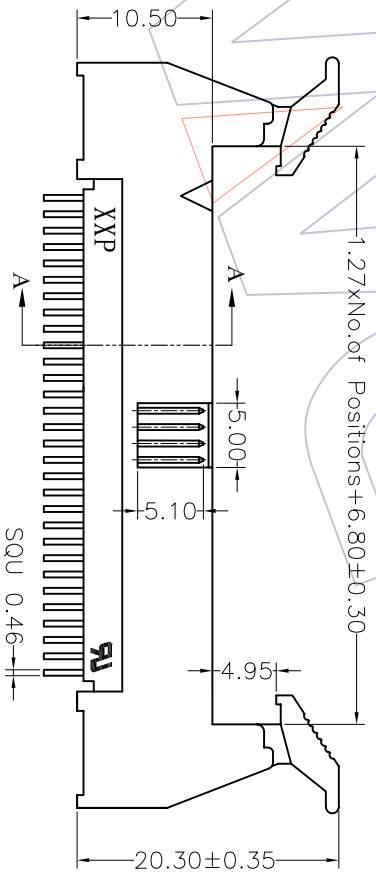
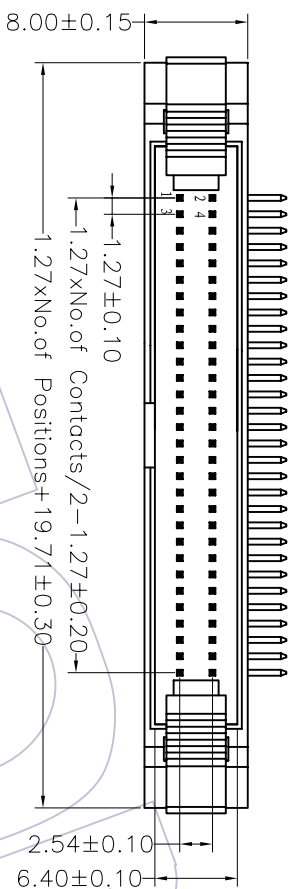

Ordering Information

3240-XX R XX B S X 1

- | | | | |
|------------|-------------------|-----------------|---------|
| No.of Pins | Contact Plating | Color Insulator | Packing |
| 10 34 | G0=Gold Flash | B=Black | A=Tray |
| 12 40 | G1=3u"Gold | U=Blue | T=Tube |
| 14 44 | G2=5u"Gold | W=White | |
| 16 50 | G3=10u"Gold | | |
| 20 60 | G4=15u"Gold | | |
| 24 64 | G5=30u"Gold | | |
| 26 80 | S0=Gold Flash/Tin | | |
| 30 100 | S1=3u"Gold/Tin | | |
| 32 | S2=5u"Gold/Tin | | |
| | S3=10u"Gold/Tin | | |
| | S4=15u"Gold/Tin | | |
| | S5=30u"Gold/Tin | | |
| | SN=Tin | | |

REV	DATE	MODIFICATION	DESCRIPTION	CHANGE	APPROVE	OPERATION	DRAW	WEIXD	SCALE	PART NO.	TITLE:
A0	08/05/13	NEW				XX	DESIGN	08/05/13	1:1	3240-XXRXXBSX1	1.27*2.54 EJECTOR HEADER 90° DIP
						XXX	CHECK		A4		
						XXX	APP		1/1		
						Angle					
						± 3'					
						DIM					
						TOL					
						PROJ.					

WCON 维峰五金电子有限公司
 WAFE HARDWARE ELECTRONICS CO. LTD