

HSF

NOTES:

Current Rating:1.5AMP
 Contact Resistance:20mΩ max
 Withstand Voltage:500V AC/DC
 Insulation Resistance:1000MΩ min
 Operation Temperature:-40°C to +105°C

Contact Material:Brass
 Contact plating:Au or Sn Over Ni
 Insulator Material:LCF+30%GF(UL94V-0)

Ordering Information

3124-XX M XX B D00 X 2

No.of Pins	Contact Plating	Color Insulator	Packaging
10 30	G0=Gold Flash	B=Black	T=Tube
14 34	G1=3u"Gold	U=Blue	P=Tube+CAP
16 40	G2=5u"Gold	W=White	R=Tape&Reel+CAP
20 44	G3=10u"Gold		
24 50	G4=15u"Gold		
26 60	G5=30u"Gold		

S0=Gold Flash/Tin
 S1=3u"Gold/Tin
 S2=5u"Gold/Tin
 S3=10u"Gold/Tin
 S4=15u"Gold/Tin
 S5=30u"Gold/Tin
 SN=Tin

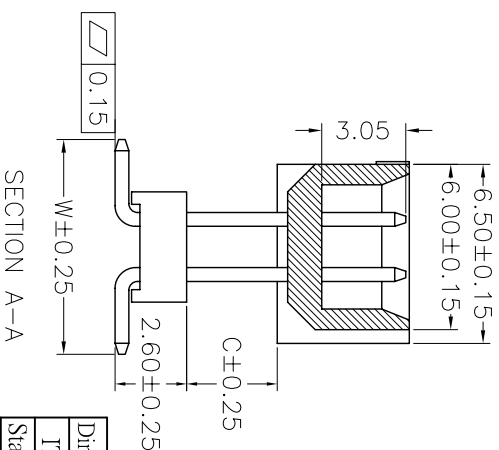
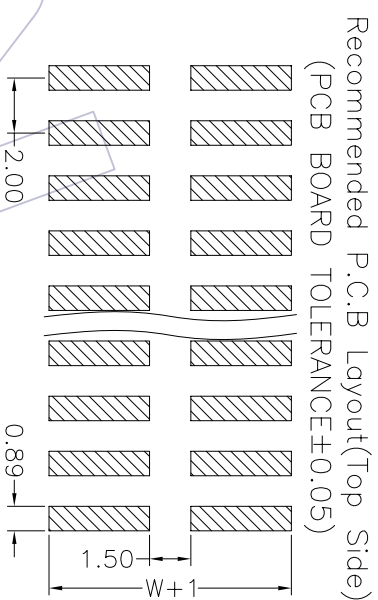
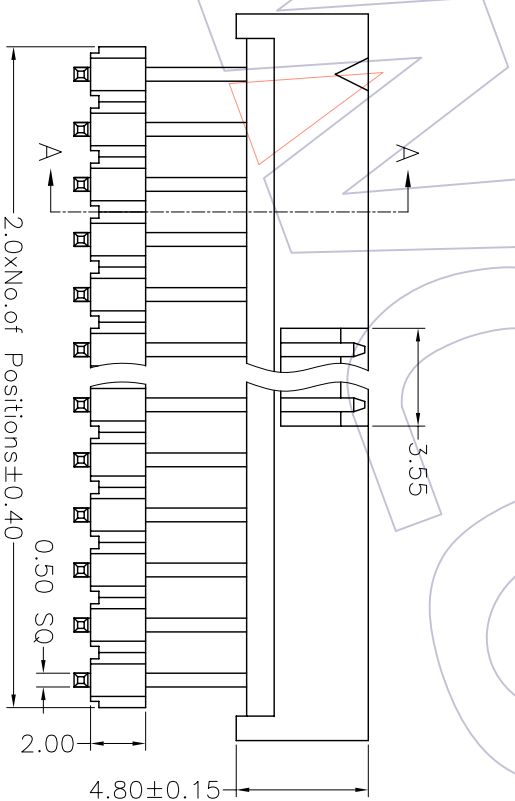
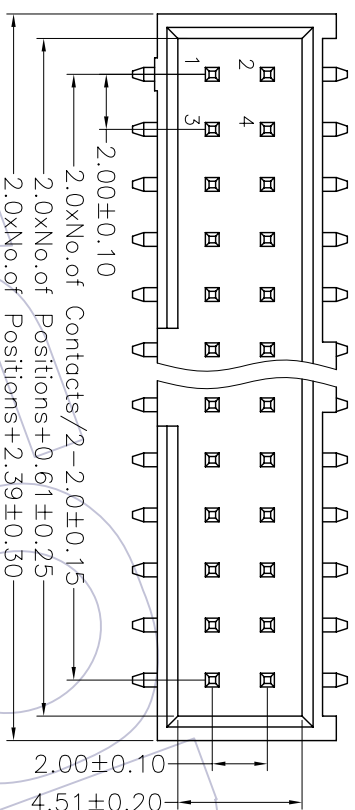

Dimension antitheses list	ITEM	W	C
Standard	7.80		
Alternate			

REV	DATE	MODIFICATION DESCRIPTION	CHANGE	APPROVE	OPERATION	DRAW	WEIXD	08/05/06	SCALE	4:1	UNIT	mm	PART NO.	3124-XXMXXBD00X2	TITLE:	2.00 BOX HEADER SMT H=4.8 SAMTEC(SHORT TYPE) ADD HOUSING
A0	08/05/06	NEW			OPERATION	DRAW	WEIXD	08/05/06	SCALE	4:1	UNIT	mm	PART NO.	3124-XXMXXBD00X2	TITLE:	2.00 BOX HEADER SMT H=4.8 SAMTEC(SHORT TYPE) ADD HOUSING
					DESIGN				SIZE	A4						
					CHECK				SHEET	1/1						
					APPROVE				PROJ.							

WCON 维峰五金电子有限公司
 WAFE HARDWARE ELECTRONICS CO. LTD

Customer NO.