

HSF

Recommended P.C.B Layout(TOP Side)
(PCB BOARD TOLERANCE±0.05)

NOTES:

- Current Rating: 7.0AMP
- Withstand Voltage: 1000V AC/DC
- Contact Resistance: 30mΩ Max
- Insulation Resistance: 1000MΩ Min
- Operation Temperature: -40°C to +105°C
- Contact Material: Brass
- Contact plating: Sn over Ni
- Insulator Material: LCP+30%G.F UL94V-0

Ordering Information

2889-1XX M XX D YN T 1

- No. of Pins per ROW: 02-30PIN
- Contact Plating:
G0=Gold Flash
G1=5μr"Gold
G2=5μr"Gold
G3=10μr"Gold
G4=15μr"Gold
G5=30μr"Gold
S0=Gold Flash/Tin
S1=5μr"Gold/Tin
S2=5μr"Gold/Tin
S3=10μr"Gold/Tin
S4=15μr"Gold/Tin
S5=30μr"Gold/Tin
SN=Tin
- Packing:
T=Tube
P=Tube+CAP
R=1pack+Reel+CAP

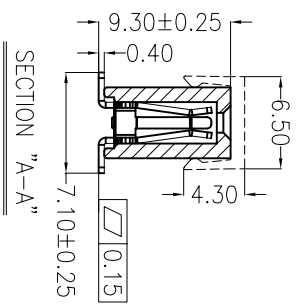
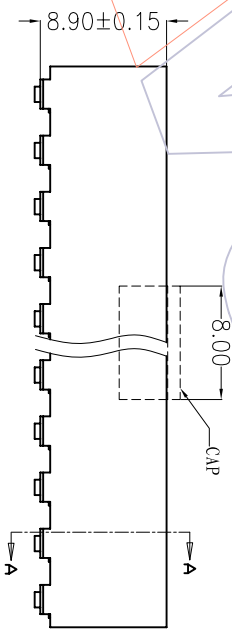
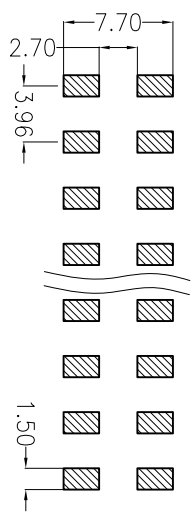
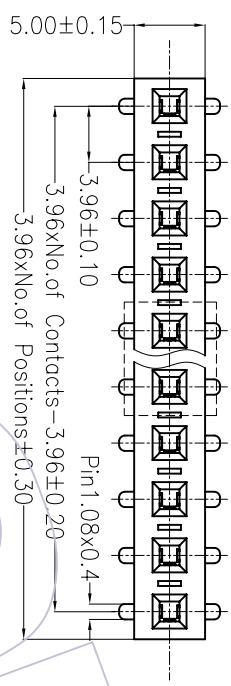

REV	DATE	MODIFICATION DESCRIPTION	CHANGE	APPROVE	OPERATION	DRAW	WEIXD	SCALE	PART NO.	TITLE:
A0	08/03/13	NEW			X.X ±0.40	DESIGN	08.03.13	2.5:1	2889-1XXMXXDUNT1	PH3.96 SINGLE SMT H=8.9
					X.XX ±0.25	CHECK		A4		
					Angle ± .3°	APPROVE		1/1		
					DIM TOL	PROJ.			Customer NO.	

WCON 维峰五金电子有限公司
WAVE HARDWARE ELECTRONICS CO. LTD