

# HSPF

**NOTES:**

Current Rating: 1.0AMP  
 Withstand Voltage: 500V AC/DC  
 Contact Resistance: 20mΩ Max  
 Insulation Resistance: 1000MΩMin  
 Operation Temperature: -40°C to +105°C

Contact Material: Phosphor Bronze  
 Contact plating: Au or Sn over Ni  
 Insulator Material: PA6T+30%G, F UL94V-0

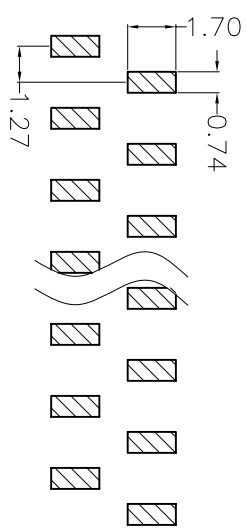
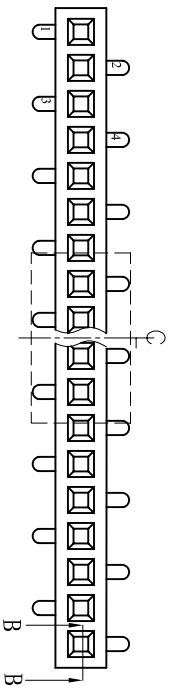

Recommended P.C.B Layout(Top Side)  
 (PCB BOARD TOLERANCE±0.05)

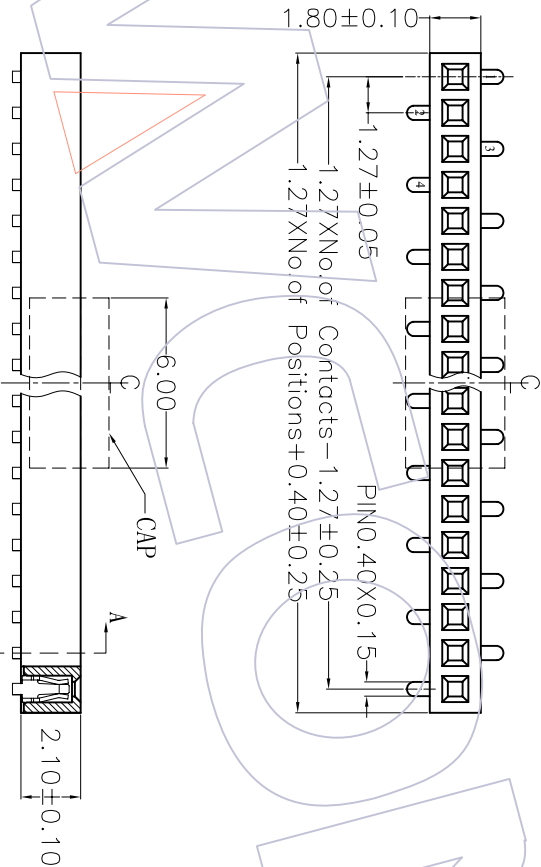
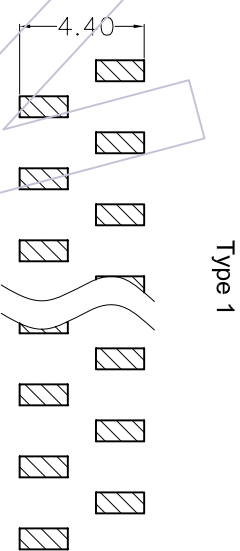

SECTION B-B

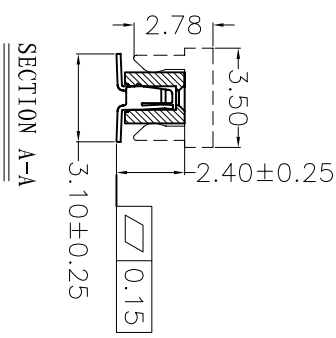

SECTION A-A

## Ordering Information

2321 - 1 XX M XX CUNT X

No. of Pins per Row: 02-50Pin  
 Contact Plating: GO=Gold Flash, G1=3μ"Gold, G2=5μ"Gold, G3=10μ"Gold, G4=15μ"Gold, G5=30μ"Gold  
 SO=Gold Flash/Tin, S1=3μ"Gold/Tin, S2=5μ"Gold/Tin, S3=10μ"Gold/Tin, S4=15μ"Gold/Tin, S5=30μ"Gold/Tin, SN=1Tin  
 Packing: T=Tube, R=Tube&Reel+CAP, P=Tube+CAP  
 Series No. 1=TYPE 1, 2=TYPE 2

TITLE	PART NO.
TYPE 1	2321-1XXMXXCUNT1
TYPE 2	2321-1XXMXXCUNT2

REV	DATE	MODIFICATION DESCRIPTION	CHANGE	APPROVE	OPERATION	SCALE	TITLE
A0	08/02/14	NEW			XXX ±0.40 XXX ±0.25 XXX ±0.15	3:1 mm	SEE TABLE
					Angle ± 3'		1.27mm SINGLE FEMALE HEADER SMT H=2.10

**WCON** 维峰五金电子有限公司  
 WAVE HARDWARE ELECTRONICS CO.,LTD